

CITY OF PORTERVILLE
CALIFORNIA
ANIMAL SHELTER PROJECT
PROJECT NO: 89-9015-88
BID NO: 21/22-CP1918 (Rebid)

BEGINNING OF ADDENDUM No. 5

Date: August 22, 2022

ITEM No. 1

Attached you will find new sheets for the D Street Improvement portions of the plans that provide details regarding the storm drain line replacement and installation of the sewer line. The attached sheets are to be incorporated into the existing plans.

ITEM No. 2

- 1) Bid Item B11 - Quantity change from 8 to 6
- 2) Bid Item B16 - Quantity change from 2 to 4

The full bid proposal is attached.

END OF ADDENDUM No. 5

/s/ Maria Bemis, Purchasing Agent

This addendum must be signed and submitted with the sealed bid proposal.
Bid proposals submitted without this sheet will not be considered.

Firm: _____

By: _____

Authorized Signature

Date: _____

- LEGEND:**
- EXISTING IMPROVEMENTS
 - EXISTING PAVEMENT
 - EXISTING RIGHT OF WAY
 - EXISTING PROPERTY LINE
 - EXISTING FENCE LINE
 - EXISTING SEWER MAIN
 - EXISTING WATER MAIN
 - EXISTING GAS LINE
 - EXISTING STORM DRAIN
 - PROPOSED WATER MAIN AND BACKFILL TRENCH



Know what's below.
Call before you dig.

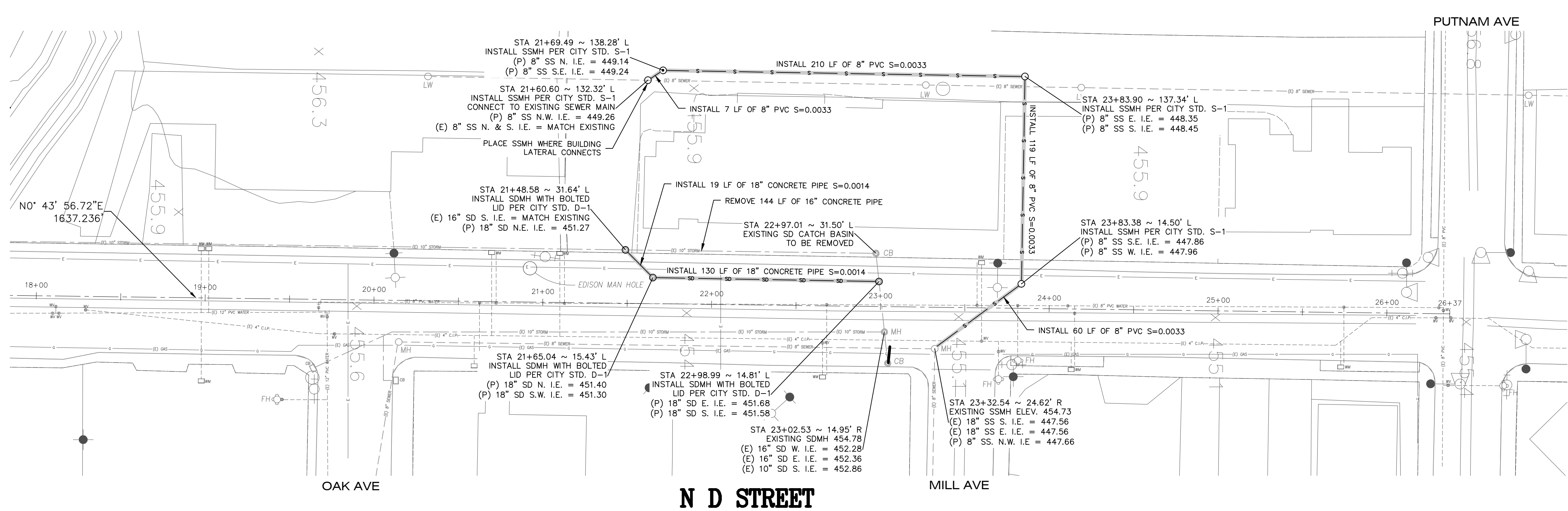
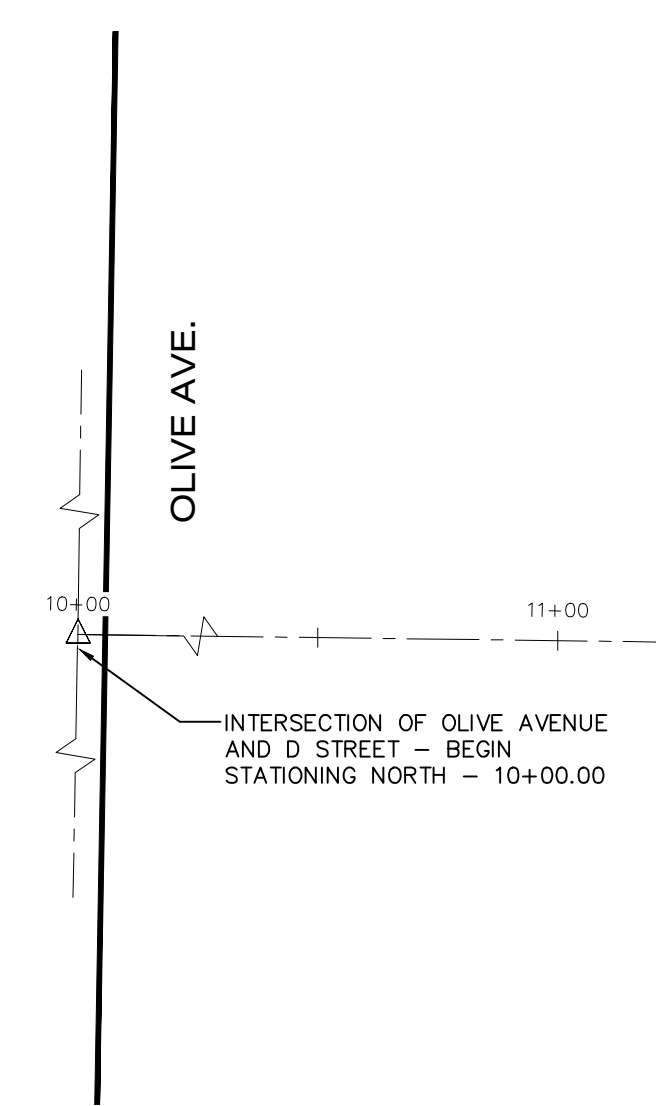

BEFORE COMMENCEMENT OF CONSTRUCTION, CONTRACTOR TO POTHOLE EXISTING UTILITY LINES (WATER, STORM DRAIN, GAS, ETC.) TO VERIFY DEPTH AND LOCATION.

CONTRACTOR, WITH ASSISTANCE FROM THE PUBLIC WORKS INSPECTOR, SHALL ATTEMPT TO VERIFY EXACT LOCATION OF PROPOSED SS LATERALS WITH PROPERTY OWNER PRIOR TO INSTALLATION

PERMANENT PAVEMENT REPLACEMENT 3" A.C. OVER 6" A.B. WITH MINIMUM 95% RELATIVE COMPACTION & PER CITY STD. P-4

THE CONTRACTOR SHALL POTHOLE AND LOCATE ALL SERVICES ALONG THE PIPELINE ALIGNMENT PRIOR TO COMMENCING WORK. AT MINIMUM, THE CONTRACTOR SHALL ANTICIPATE EACH LOT TO HAVE UNDERGROUND UTILITIES SUCH AS GAS, WATER, CABLE TV AND ELECTRICAL.

CONTRACTOR IS RESPONSIBLE TO TIE-OUT STREET CENTERLINE MONUMENTS (SUB-SURFACE) TO AN AREA OUTSIDE THE CONSTRUCTION LIMITS. PROVIDE CITY WITH TIE INFORMATION. REPLACE MONUMENTS, IF DESTROYED, WITH CITY STANDARD M-2, TYPE C MONUMENT, PER DETAIL SHEET 10A, AND FILE CORNER RECORD WITH TULARE COUNTY SURVEYOR PER LAND SURVEYORS ACT.

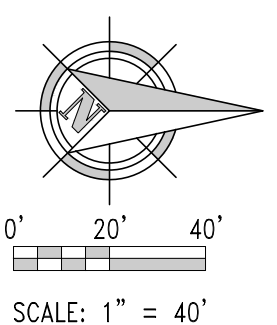

CITY OF PORTERVILLE
ENGINEERING DIVISION
291 N. MAIN ST. PORTERVILLE, CALIFORNIA 93257 559 782-7462

| | |
|------------|-----------|
| DESIGN BY | GG |
| DRAWN BY | GG |
| CHECKED BY | DC |
| DATE | 8/20/2022 |

REVIEWED BY: *Javier Sanchez Jr.* AUGUST 20, 2022
ENGINEERING & PROJECT MANAGEMENT DIRECTOR

APPROVED BY: *Daniel Cervantez* AUGUST 20, 2022
ACTING CITY ENGINEER

| | |
|--------------|------|
| REVISION NO. | DATE |
| | |
| | |



D STREET STORM AND SEWER REPLACEMENT PROJECT

SHEET
1
OF
1

BID PROPOSAL FOR
 ANIMAL SHELTER PROJECT
 PROJECT NO: 89-9015-88
 BID NO.: 21/22 - CP1918

TO THE PURCHASING AGENT
 City of Porterville
 291 N. Main Street
 Porterville, CA 93257

We, the undersigned bidder, having carefully examined the location of hereinafter described work and the plans and project manual thereof, thereby propose to furnish, all in strict accordance with said plans and project manual, all the materials, labor and equipment necessary for the completion of this project for the price set forth in the following bid, to wit:

BASE BID "A": Animal Shelter

| ITEM | DESCRIPTION | QTY. | UNIT | AMOUNT |
|-----------------------------------|--|------|------|-----------|
| A1. | Animal Shelter Tenant Improvement Work | 1 | LS | |
| A2. | Dog Park | 1 | LS | |
| A3. | Site Improvements | 1 | LS | |
| TOTAL BID PART A (Figures) | | | | \$ |

Total amount of BASE BID "A" _____ Dollars
 And _____ Cents (Words)

BASE BID "B": D Street Improvements

| ITEM | DESCRIPTION | QTY. | UNIT | AMOUNT |
|------|---------------------------|------|------|--------|
| B1. | Mobilization & Clean-Up | 1 | LS | |
| B2. | Traffic Control | 1 | LS | |
| B3. | Demo Existing Flat Work | 2000 | SF | |
| B4. | Demo Existing Retain Curb | 200 | LF | |
| B5. | Demo Existing Pavement | 600 | SF | |

| ITEM | DESCRIPTION | QTY. | UNIT | AMOUNT |
|-----------------------------------|---|------|------|-----------------|
| B6. | Furnish & Install Conduits, Wiring, Handholes, Pull Boxes and Appurtances for Street/Trail Lights per SCE and City Plans. (Price is set for bidding purposes and will be negotiated after award if SCE plan is not received in time for bid.) | 1 | LS | \$35,000 |
| B7. | Furnish & Install Curb and Gutter | 300 | LF | |
| B8. | Furnish & Install Pavement Patch | 600 | SF | |
| B9. | Furnish & Install 10' Wide Sidewalk and Parkway | 3000 | SF | |
| B10. | Furnish & Install New 6"-12" Retain Curb | 200 | LF | |
| B11. | Furnish & Install Tree Wells | 6 | EA | |
| B12. | Furnish & Install Irrigation | 250 | LF | |
| B13. | Furnish & Install 18" SD Line | 540 | LF | |
| B14. | Furnish & Install Storm Drain Manhole | 3 | EA | |
| B15. | Furnish & Install 8" SS Line | 500 | LF | |
| B16. | Furnish & Install Sewer Manhole | 4 | EA | |
| B17. | Furnish & Install Curb Ramp @ Mill & D Street | 1 | EA | |
| B18. | Furnish & Install Modified C-20 Drive Approach | 800 | SF | |
| B19. | Furnish & Install Decorative Trash Receptacle | 2 | EA | |
| B20. | Furnish & Install Decorative Bench | 2 | EA | |
| B21. | Relocate Building Sign | 1 | EA | |
| TOTAL BID PART B (Figures) | | | | \$ |

Total amount of **BASE BID "B"** _____ Dollars
And _____ Cents (Words)

Total amount of BASE BID "A" + "B" _____ Dollars
and _____ Cents (Words)

(Amount to be shown in both words and figures. In case of discrepancy between words and figures, the words shall prevail.)